

Composite Panel

This ventilated façade system is manufactured directly in the composite panel production centre that Cortizo has in Spain. This factory, with a daily production capacity of 5,400 m², guarantees the storage and immediate supply of this system in the various panel types and their finishes

Additionally, fabrication centres – with the latest generation of pantographs that are situated in production and distribution centres throughout Europe, facilitate the delivery of this constructive solution according to the modulation specifications that are defined in each of the projects.

Technical Departments that are exclusive for this product provide personalised help that is integral and specific in every architectonic project which includes Cortizo Composite Panel.

Certificates:



Spain



Great Britain



Poland



France



Furthermore, to ensure the quality in the assembly systems, the manufacturing and fabrication processes of the composite panel are certified by way of ISO 9001.



Composite Panel

Categories achieved at test centre

A efficient, economic, stylish and sustainable construction solution for re-covering building façades that are made up of 2 aluminium sheets joined by a nucleus of thermoplastic resins.

A composite panel comprising of an external layer of aluminium alloy triple coated with PvdF paint (polyvinyl flouride) that offers great resistance to corrosion and ageing. The internal nucleus is made up of thermoplastic resins (polyethelene).

This material union provides the composite panel with some excellent mechanical properties: high impact resistance, increased rigidity and reduced weight. It is a product designed and tested to integrate in to buildings with increased thermal and accoustic features.

Fire reaction classification

FR - B-s-1,d0
(according to EN-13501-1:2007 norm)

Transmittance

PE-U_{st}(W/m²K) = 3,38
FR-U_{st}(W/m²) = 5,62
For a panel dimensioned at 1,48 x 1,23 m.
Test according to EN ISO 12567-1:2000 norm

Accoustic insulation

RW (C;Ctr)(dB):(C;Ctr) = 26 (-1;-3)
For a panel dimensioned at 1,23 x 1,48 m.
Test according to EN ISO 140-3:1995 norm

Finishes

Painted in 22 solid & metallic colours in stock.

Pure White	Shadow grey	Metallic silver
Arctic White	Dark green	Metallic champagne
Garnet	Brown	Metallic bronze
Intense red	Black	Metallic Titanium
Orange	Ultramarine blue	Carbon
Traffic yellow	Metallic White	Metallic blue
Beige	Grey metallic	Jade green
		Metallic copper

All other RAL colours available on request



Panel types:

PE- standard (4mm. panel thickness - Al 0,5 m.)
FR - fire retardant (4mm. panel thickness - Al 0,5 m.)
INTDESIGN-interiors (3mm. panel thickness - Al 0,3 m.)

Aluminium alloys

3005H44 / 3105H44 / 3105H46 / 5005H22

Panel weight : : **PE-** 5,46 Kg/m² **FR-** 8,02 Kg/m²
Intdesign- 3,85 Kg/m²

The composite panel is also available with the fire retardant option denominated FR (Fire Retardancy), that guarantees answers with respect to hypothetical fires. It is a 4 mm panel made up of 0,5 mm thick aluminium sheets, coated with PvdF paint with a thickness of 25/35 microns on the external face and a central nucleus consisting of a mineral composition and 3 mm thick polyethelene.

This range is completed with the INTDESIGN 3 mm thick panel which is ideal for internal applications, signage, digital printing, stands etc.

Certificates

- Spain: **DIT**
- Great Britain: **BBA**
- Poland: **Wyrób budowlany**
- France: **CSTB**

Fixing systems



CH
Hanging system



SZ
Male-Female system



Riveted system



Glued system

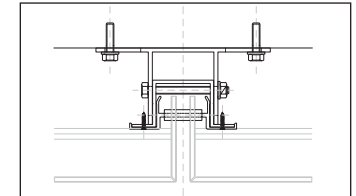

CH-Hanging system

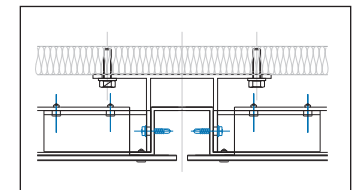

Riveted system

Sheet dimensions

	Width		Length
	Stock	1000-1250-1500	4000-5000
PE	Stock	1000-1250-1500	(Min/max) 2000/6000
	Made to measure	1000-1250-1500	(Min/max) 2000/6000
FR	Stock	1000-1250-1500	4000-5000
	Made to measure	1000-1250-1500	(Min/max) 2000/6000
INTDESIGN	Stock	1500	3050-5050
	Made to measure	1000-1250	(Min/max) 2000/6000