

Cor-70 Industrial System with thermal break

A hinged window system that was conceived with the object of satisfying the needs of a determined market segment for an economical window system, simple but versatile with many features.

With a 70 mm frame depth and Euro Groove opening gearing, this innovation from the R&D Department has thermal transmission from only $0,8 \text{ W/m}^2\text{K}$ in order to adapt to distinct climatic severities and material demands on energy efficiency.

Its simplicity in fitting and reduced need for labour allows for a more industrialised manufacture resulting with time and cost savings at the end.

It features a straight style in both sash and bead.

A glazing capacity of 55 mm that allows the use of energy efficient glazing and compositions with large thicknesses and affords this system excellent acoustic and thermal features.



Cor-70 Industrial System with thermal break

Transmittance

Uw from 0,8 (W/m²K)

Please consult typology, dimensions and glass

Acoustic insulation

Maximum glazing: 55 mm.

Maximum acoustic insulation **Rw=44 dBA**

Finishes

Possibility of dual colour

Colour powder coating (RAL, mottled and rough)

Wood effect powder coating

Anti-bacterial powder coating

Anodized

Categories achieved at test centre

Air permeability
(EN 12207:2000): Class 4

Water tightness
(EN 12208:2000): Class E1200

Wind resistance
(EN 12210:2000): Class C5
Reference test 1,23 x 1,48 m. 2 sashes

Burgular resistant
(EN 1627:2011): Grade RC2 (WK2)
Reference test 2,52 x 1,47 m. 1 sash
with EVO SECURITY hardware

Possibility of incorporating hardware with
concealed hinges.

Possibility of incorporating security hardware
Evo Security.



Sections

Frame 70 mm.
Sash 78 mm.

Profile thickness

Window 1,5 mm.
Balcony 1,7 mm.

Polyamide strip length from 32 to 35 mm.

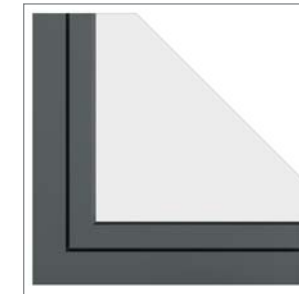
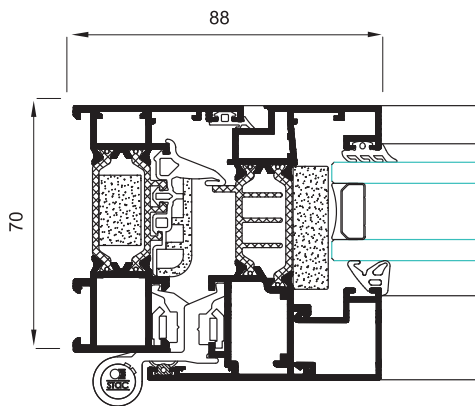

Opening possibilities

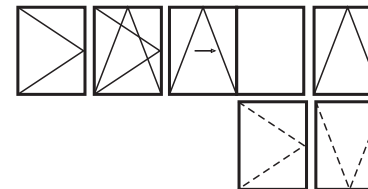

Open in: practicable, turn-tilt, parallel tilt, hinged.

Open out: practicable, projecting-sliding.

Maximum dimensions/sash

Width (L) = 1.500 mm.
Height (H) = 2.600 mm.

Please consult regarding maximum weight and dimensions according to types

Maximum weight/sash

120 Kg.